

REVISION HISTORY		
Revision	Description	Date
A	Release	17/05/21

# INTERNAL LEVER HANDLE

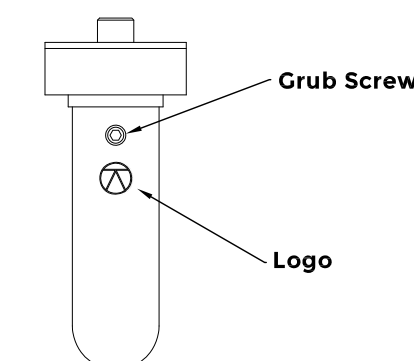
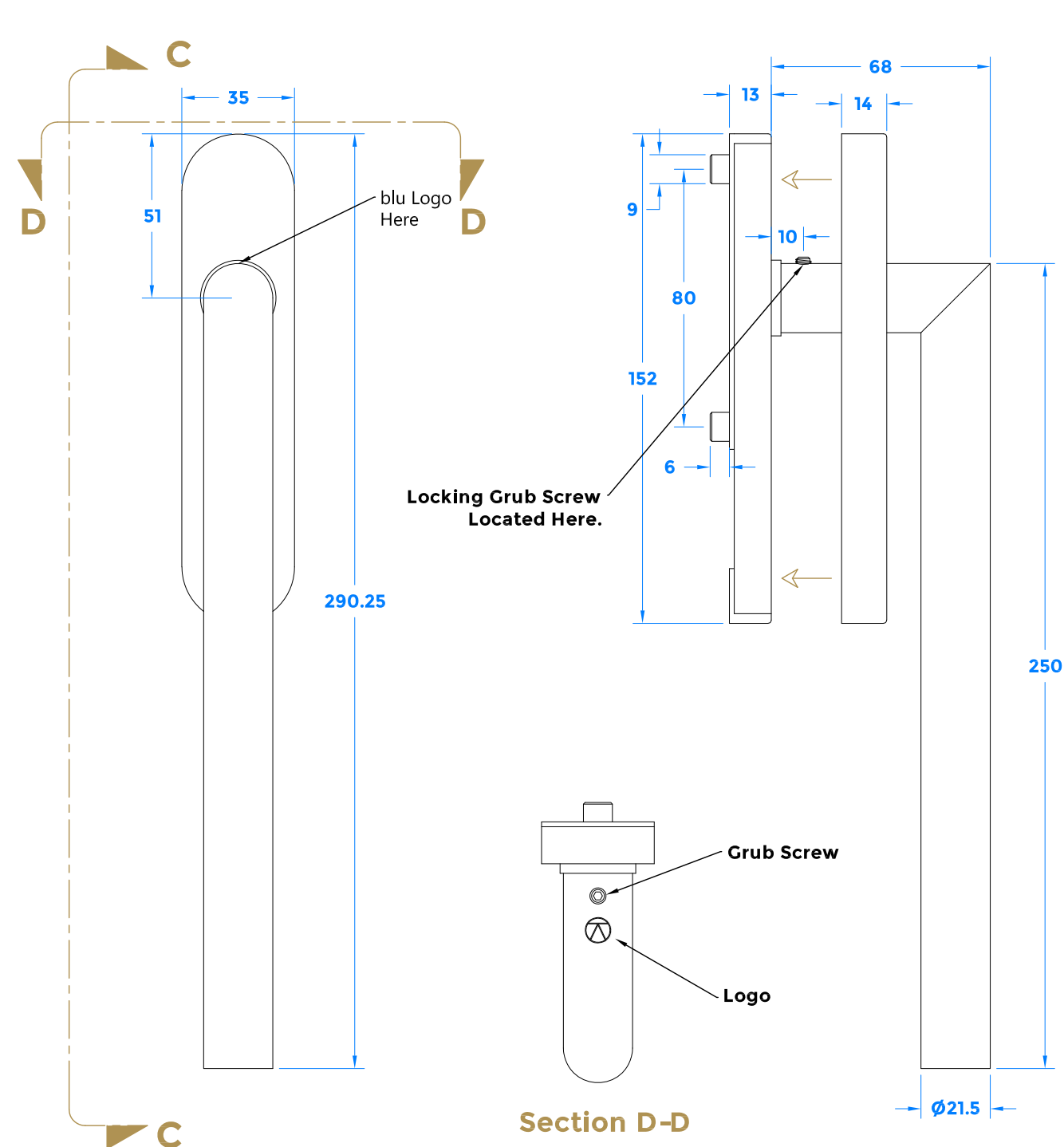

Section D-D

Section C-C

# EXTERNAL FLUSH PULL

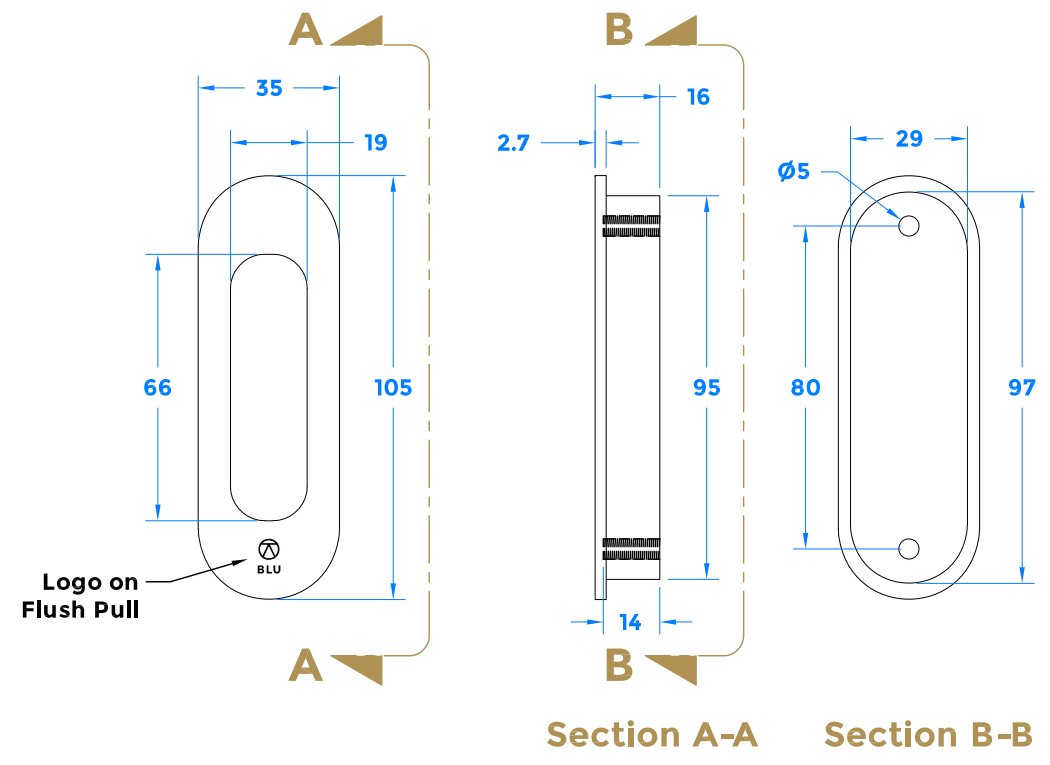

Section A-A

Section B-B

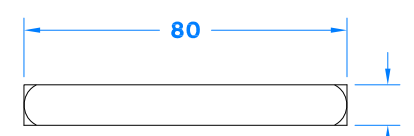

1 x 10x10x80mm SPINDLE

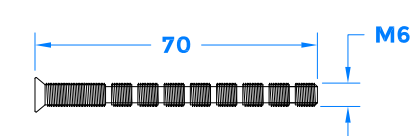

2 x MACHINE SCREWS

## Assembled View

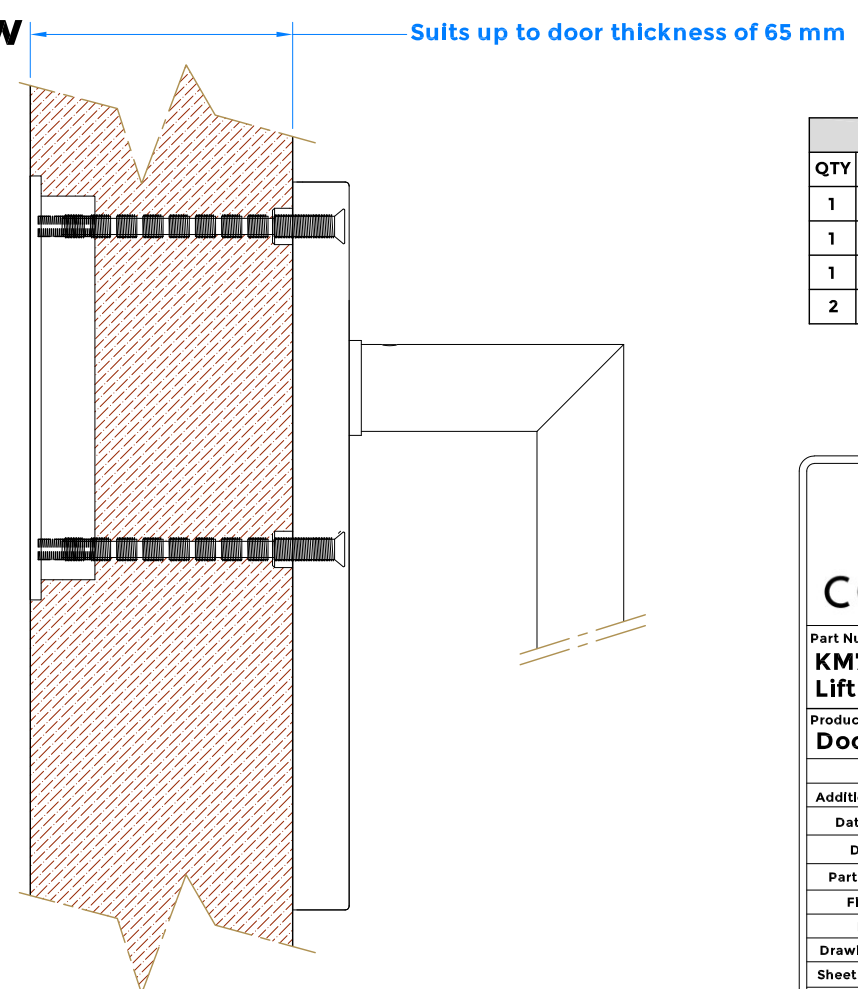

WHATS INCLUDED IN THE BOX	
QTY	DESCRIPTION
1	INTERNAL LEVER HANDLE
1	EXTERNAL FLUSH PULL
1	80 x 10mm SPINDLE
2	70mm M6 MACHINE SCREWS



coastal-group.com  
*Shaping the future*

**COASTAL**

Part Number / Drawing Title:  
**KM760B**  
**Lift & Slide Handle with Flush Pull**

Product Range:  
**Door Handles**

Material:	316 Stainless Steel
Additional Info:	Universal - Non Handed - No Euro Profile
Date Drawn:	17/05/2021
Drawn By:	Phillip Walklett
Part Number:	KM760B-316-SSS
File Name:	KM760B-316-SSS.dwg
Revision:	A
Drawing Scale:	Not to Scale
Sheet Number:	1 of 1

**THIRD ANGLE PROJECTION**

This drawing and specification are the property of Coastal Specialist Ironmongery Ltd. they are issued in strict confidence and shall not be reproduced, copied or used without written permission.  
E&OE - All dimensions are specified in mm.