

**DG Supplyline Ltd**

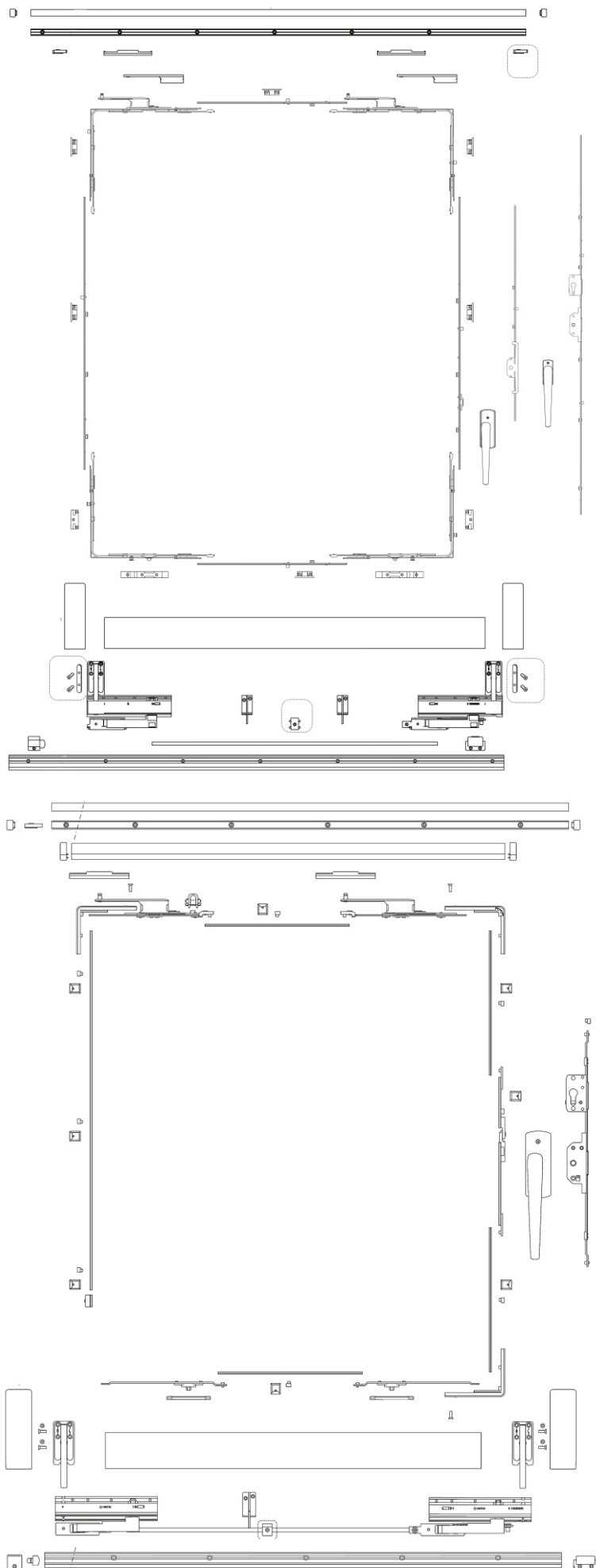

**Tilt and Slide**  
**Product Guide 2013**



There are so many options and variations in the world of tilt & slide hardware that it can often be a difficult task to carry out repair and replacement work on older, broken systems.

In many cases, faults on tilt & slide doors can usually be narrowed down to just one or two damaged components, but if the system is an older obsolete type then this can cause no end of problems in regards to finding replacements.

Thankfully, we at DG Supplyline are experts in tilt & slide hardware, and it's very rare that we cannot find a solution to each and every job.

This guide has been created to outline some of the points you will need to make note of when dealing with tilt & slide, as well as what information you will need to gather to enable us to find the correct solution for each particular job.



## Manufacturer

Usually the easiest and best starting point to any tilt & slide enquiry is to work out the manufacturer of the gearing. We can supply parts from all manufacturers of tilt and slide hardware, the most common systems in the UK being Hautau, Siegenia (Si), Roto and GU.

Check for markings or codes on the components around the sash, **particularly on the bogies** (roller carriages).

## The Door

Knowing the dimensions of the sash, whether it is a tilt & slide or lift & slide system and what material the door is made of will go a long way to identifying the system.

Knowing how heavy the door is can also help as some systems work for different weights, although this information can sometimes be gathered from the markings found on the components

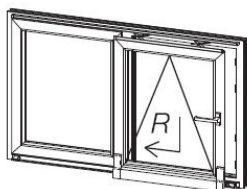

Handing

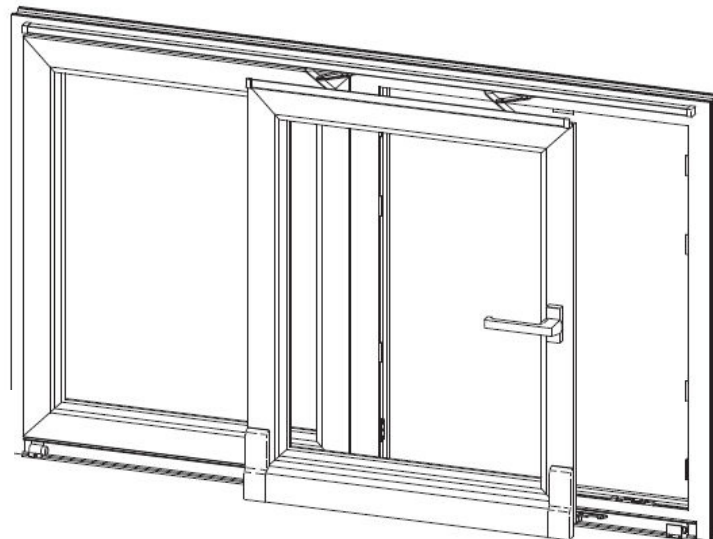
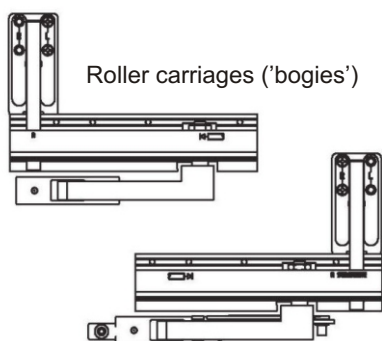
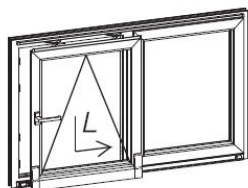

Top stay system / top rail & covers



## The Parts

If you only need to replace one or two damaged components, a great way to help us to identify them is to send us some photos.

Whilst taking photos don't forget to take some of the other parts of the system too, even if those components are not damaged, all information helps!

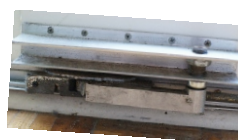

## Replace or Re-Gear

In some cases a like-for-like replacement for older components will not be available, and in this instance you will need to re-gear part or all of the door with currently available parts.

For example, when replacing obsolete bogies, you may end up having to change everything at the bottom of the door (bogies, running rail, covers etc) due to incompatibility between older and newer systems.



If you have any questions regarding spiral balances & sliding sash components please contact our sales team.  
**Tel: 01702 351 911 Fax: 01702 346 331 Email: [sales@dgsupplyline.co.uk](mailto:sales@dgsupplyline.co.uk)**



# Slide Door Survey Sheet

Complete as many sections as possible



Company name: .....

Tel: ..... Email: .....

Sash Rebate Height:

\_\_\_\_\_ mm

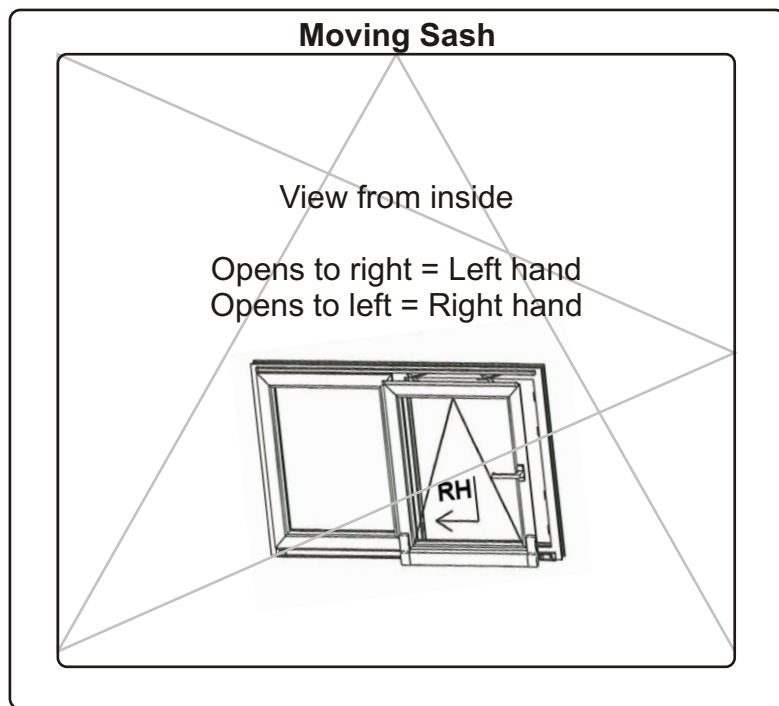

Track length \_\_\_\_\_ mm

Sash Rebate Width: \_\_\_\_\_ mm

HANDING: R/H ☐  
L/H ☐

## Material

UPVC ☐ Timber ☐ Ali ☐

## EUROGROOVE POSITION:

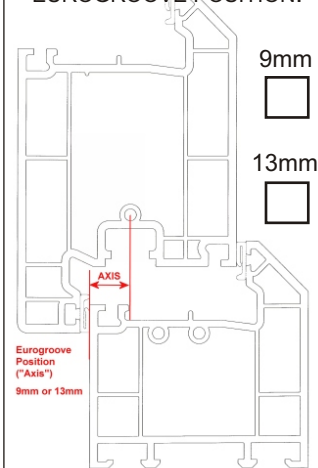

**HANDLE TYPE** Flat Blade ☐  
7mm Spindle ☐ Forked ☐

**Locking Method** Locking handle ☐  
Euro Cylinder ☐

Tilt & Slide: ☐  
Lift & Slide: ☐

ALL VISIBLE PART NUMBERS / LOGOS / MARKINGS: **IMPORTANT** - check all components for codes, especially the bogies as they will almost always display a serial number of some description.

.....

.....

.....

.....

**DG Supplyline Ltd 122-124 Prince Avenue Southend On Sea Essex SS0 0NW**

**Tel: 01702 351 911 Fax: 01702 346 331 Email: sales@dgsupplyline.co.uk**

**Visit us online at [www.dgsupplyline.co.uk](http://www.dgsupplyline.co.uk)**